

CONDENSATEURS / CAPACITORS / KONDENSATOR

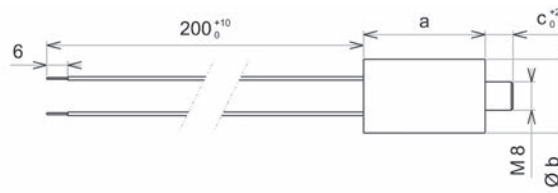
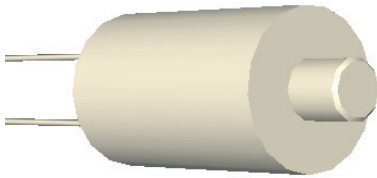

Code	µF	a	Øb	c	Boîtier / Housing / Gehäuse	Fils / Wires / Verdringung	U _{max.}	T°C
19001	0,5	35	21	8	Aluminium	0,50	400 Volts	-25°C / +85°C
19040	1	48	21	8	Aluminium	0,50	400 Volts	-25°C / +85°C
19005	1,5	48	21	8	Aluminium	0,50	400 Volts	-25°C / +85°C
19008	2	48	21	8	Aluminium	0,50	400 Volts	-25°C / +85°C
19011	2,5	48	25	8	Aluminium	0,50	400 Volts	-25°C / +85°C
19012	3	48	25	8	Aluminium	0,50	400 Volts	-25°C / +85°C
19049	3,5	48	25	8	Aluminium	0,50	400 Volts	-25°C / +85°C
19019	4	66	25	8	Aluminium	0,50	400 Volts	-25°C / +85°C
19053	4,5	66	25	8	Aluminium	0,50	400 Volts	-25°C / +85°C
19131	5	49	30	8	Aluminium	0,50	400 Volts	-25°C / +85°C
19016	6	66	28	8	Aluminium	0,50	400 Volts	-25°C / +85°C
19248	7	66	28	8	Aluminium	0,50	400 Volts	-25°C / +85°C
19147	8	66	32	8	Aluminium	0,50	400 Volts	-25°C / +85°C
19065	10	66	35	8	Aluminium	0,50	400 Volts	-25°C / +85°C
19061	12	84	35	8	Aluminium	0,50	400 Volts	-25°C / +85°C
19140	14	66	40	8	Aluminium	0,50	400 Volts	-25°C / +85°C
19149	16	84	35	8	Aluminium	0,50	400 Volts	-25°C / +85°C
19067	18	68	45	10	Aluminium	0,50	400 Volts	-25°C / +85°C

BOITIERS ET CONNECTEURS / BOXES AND CONNECTORS / KLEMMKASTEN UND ANSCHLUßSTECKER

Code	BOITIER / BOX / KLEMMKASTEN	Vis / Screws / Schrauben	Presse étoupe / Grommet / Verschraubung	Joints caoutchouc / rubber joints / Gummidichtungen
39658	Plastique / Plastic / Kunststoff	2	1	2

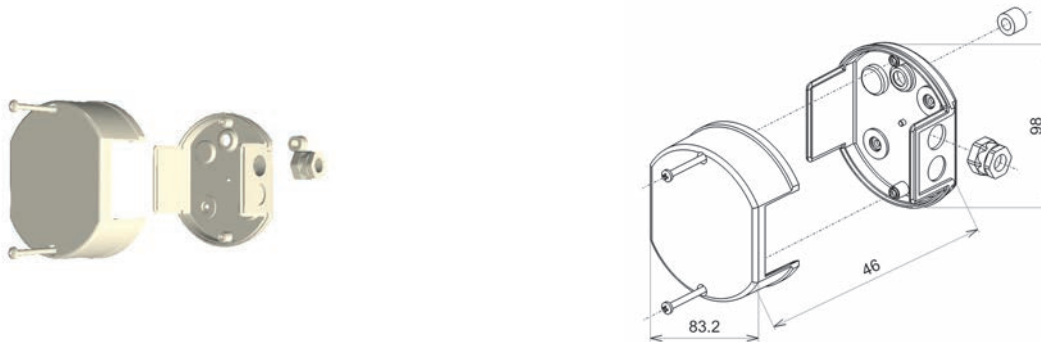

ACCESSOIRES

Code	Normes / Standards / Normen	U max.	Conducteurs / Conductors / Leiter	Schéma / drawings /
09145	VDE / UL / CSA	400 Volts	0,08 - 1,5mm ² (AWG28-16)	A
09172	VDE / UL / CSA	400 Volts	0,08 - 1,5mm ² (AWG28-16)	B

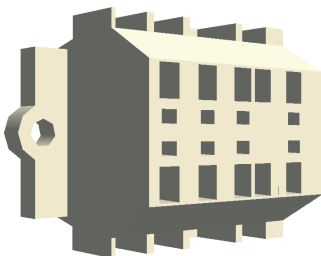

A

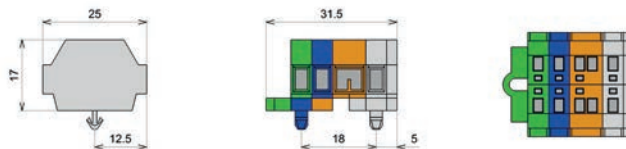

B

